



## BFP Continuous Pressure Double-Check Backflow Preventer

The Cash Acme BFP is a double-check backflow preventer with an intermediate vacuum breaker that is designed to prevent the backflow of contaminated water into the potable water supply.

Cash Acme's BFP is designed for use on small supply lines and protects against both backflow and back-siphonage into potable supply lines for continuous pressure applications.

- Prevents polluted water from entering the potable water supply system: *Prevents the reverse flow of water into supply lines.*
- Internal plastic parts and high temperature elastomer seals: *Resists corrosion.*
- Designed for use at cross-connections: *Perfect for boiler feed lines, dairy processing, chlorinators, livestock drinking fountains and numerous other similar applications*
- Listed by ASSE and CSA: *Inspector friendly, peace of mind!*



### TYPICAL INSTALLATION

A typical application for the BFP is in the boiler feed line. **Type BFP** is designed to discharge water under certain conditions. To prevent the possibility of water damage it is recommended that it always be fitted with a drain line. Always install the **Cash Acme BFP** in an easily accessible location for maintenance purposes and so that it can be frequently observed. The **BFP** should be located as close as possible to the fixture or appliance being served; however, it should be located on the upstream side of any boiler feed water pressure regulator for supply pressure considerations.

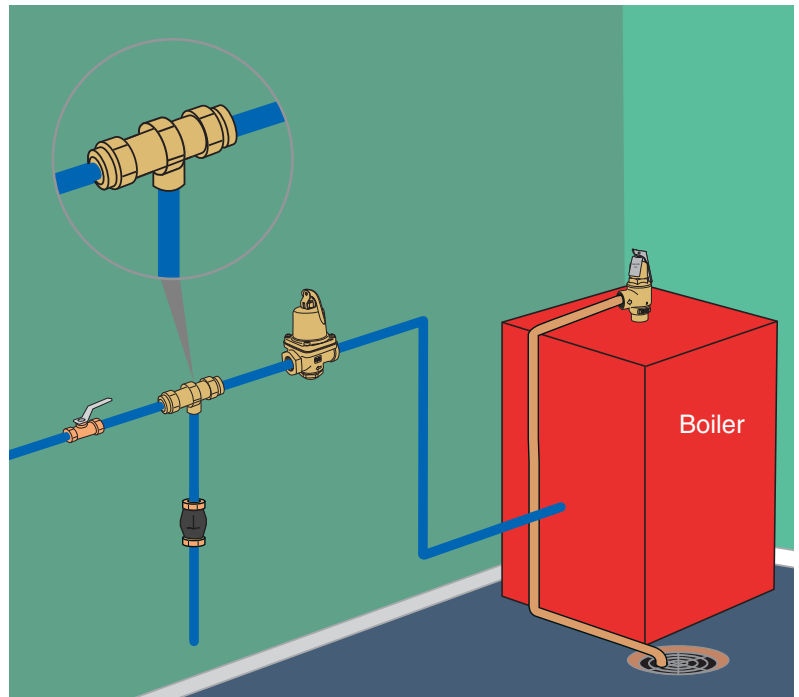



# BFP Continuous Pressure Double-Check Backflow Preventer

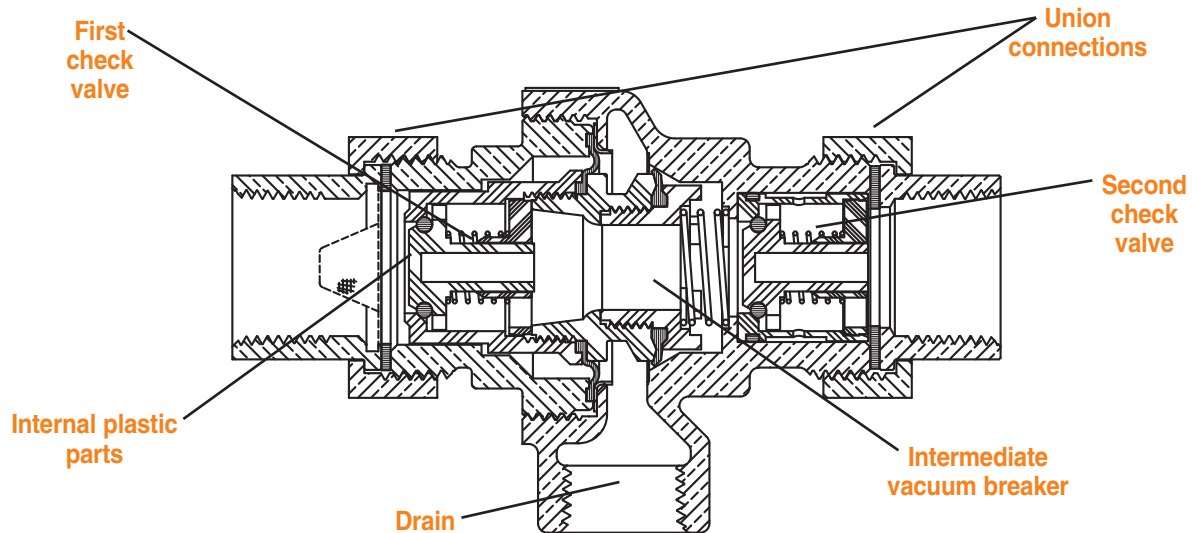

## MODELS/SIZES

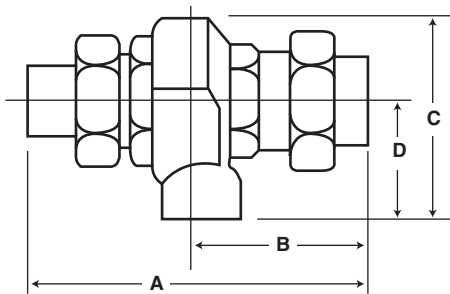

Dimensions	A	B	C	D
1/2"	5-3/32"	2-7/16"	1-25/32"	2-63/64"
3/4"	5-5/32"	2-17/32"	1-25/32"	2 63/64"

## CONNECTIONS

Threaded (NPT) . . . . . 1/2" and 3/4"

## CERTIFICATIONS

The **Cash Acme BFP Backflow Preventer** is certified to product standards **ASSE 1012** and **CSA B.64.3**.